

CLUTCH RELEASE CYLINDER REMOVAL/INSTALLATION

B3E051041920W01

1. Remove the under cover.
2. Remove in the order indicated in the table.
3. Install in the reverse order of removal.

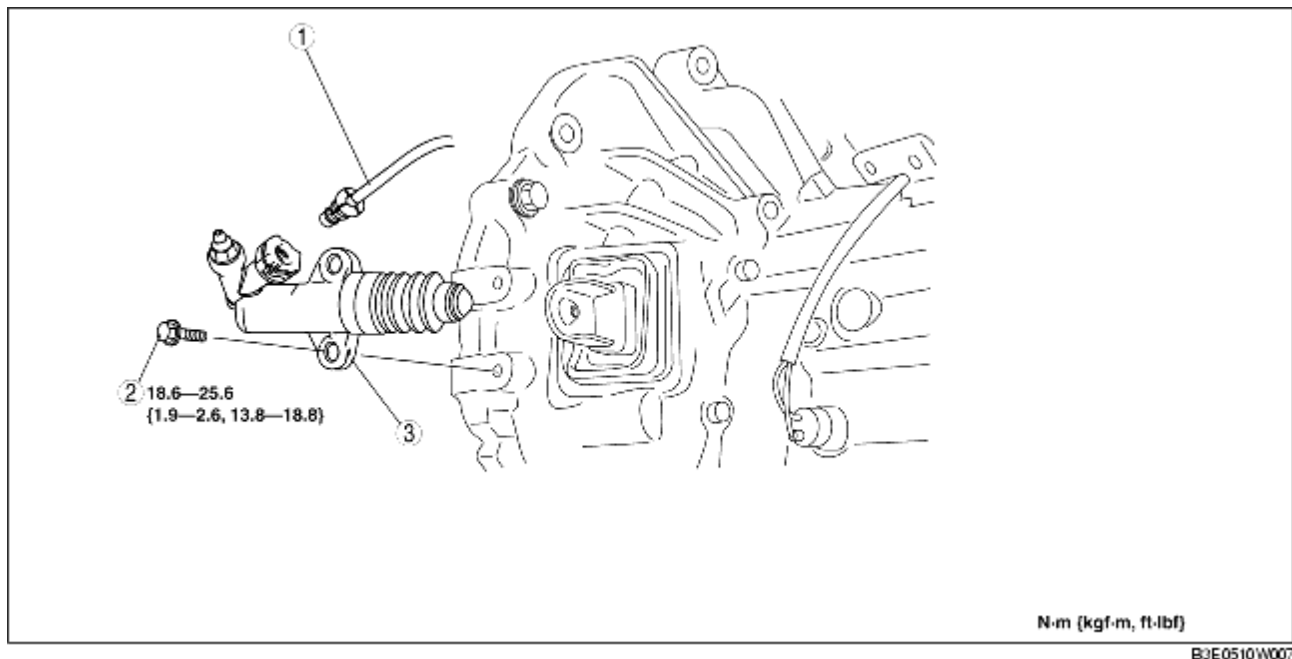

B3E0510W007

1	Clutch pipe
2	Bolt
3	Clutch release cylinder

Clutch Pipe Removal Note

1. Pull the clip to the position shown in the figure and pull out the clutch pipe connector straight to detach it.

F35M-R

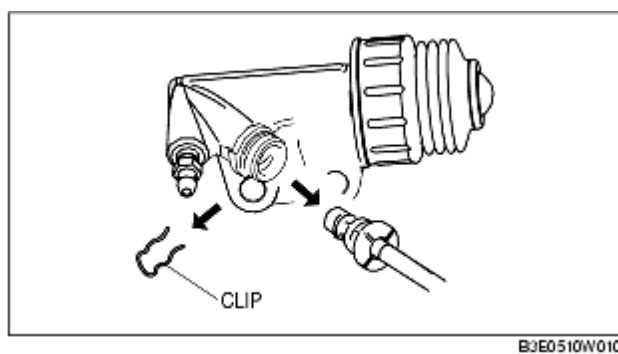
G35M-R**Clutch Pipe Installation Note**

1. Return the clip to the position shown in the figure.

Caution

- Verify that there is no chipping or damage to the seal ring of the clutch pipe connector.

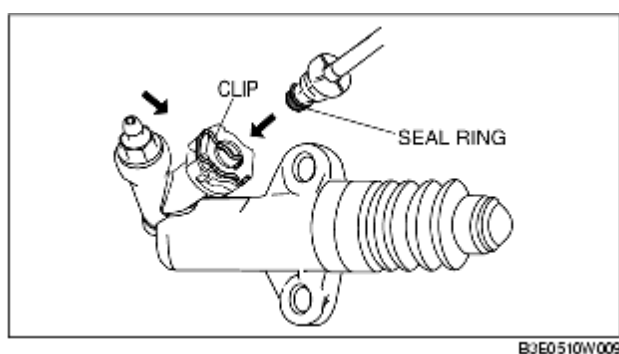
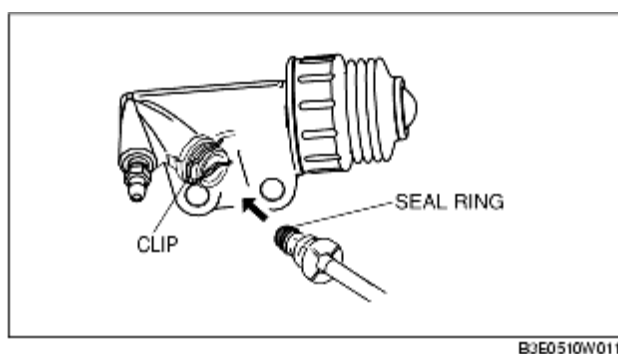
F35M-R**G35M-R**

2. Insert the clutch pipe connector straight.
3. Pull the clutch pipe to verify that it does not come off, and reinsert it completely.